

Accessing Moodle/Enrolling in Moodle:

You can access Moodle from [the Nest \(our intranet\)](#) by clicking on the Moodle icon:

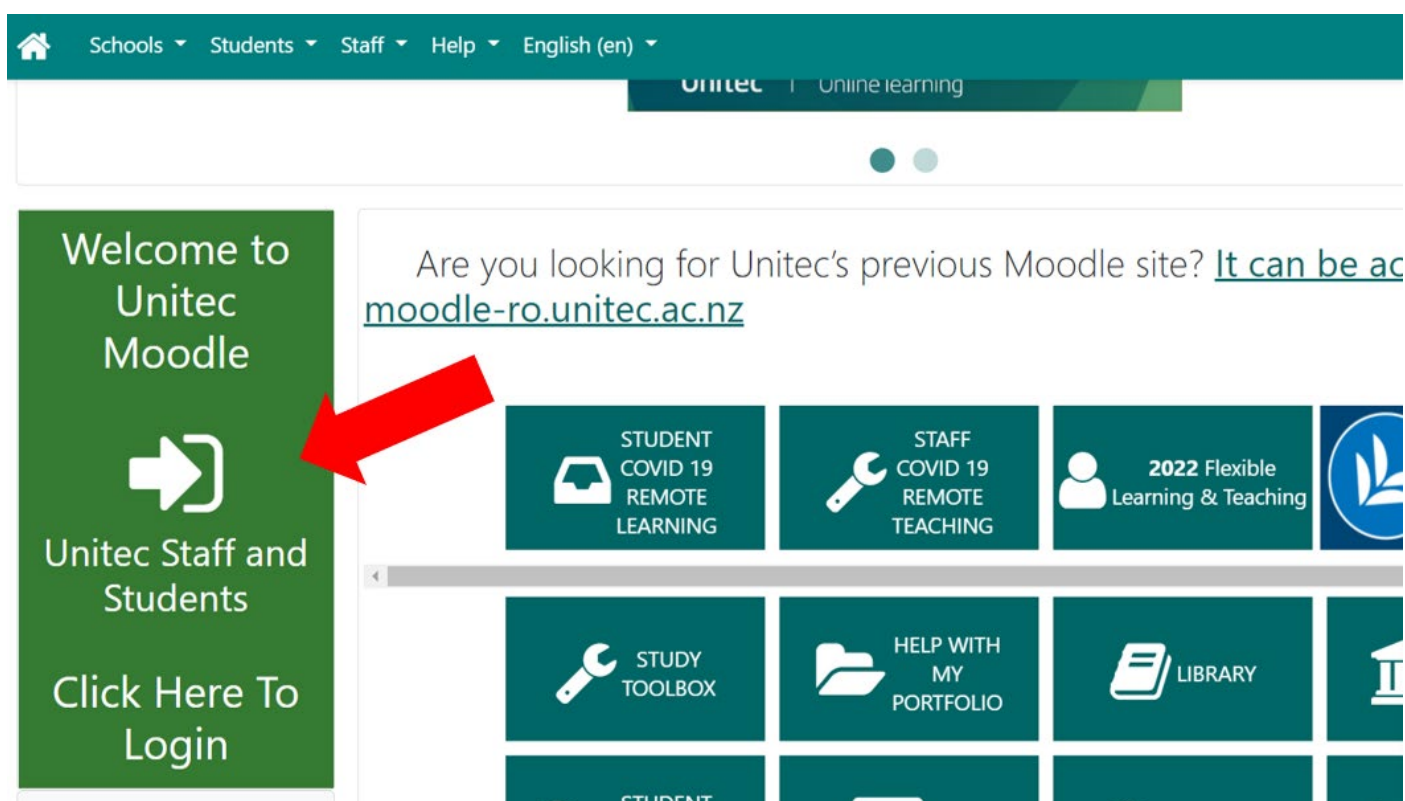

## 1. Please log in into the New Updated Moodle:



**2. Please sign in with your Unitec email address and password:**

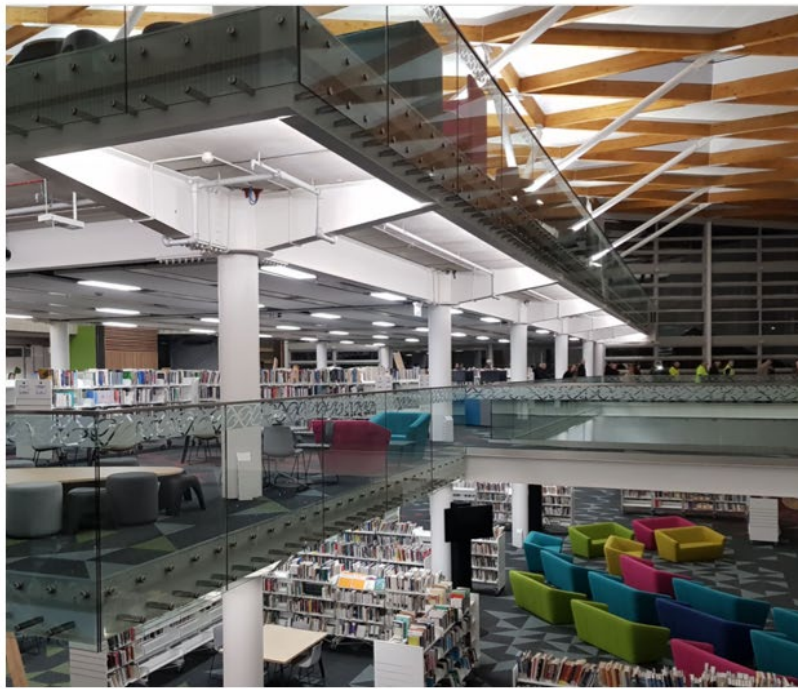

Sign in

someone@example.com

\*\*\*\*\*

Sign in

**3. Please scroll down and type "Code of Practice" in Search Course box:**

🎓 Computing, Electrical and Applied Technology

🎓 Creative Industries

🎓 Environmental and Animal Sciences

🎓 Health and Safety (do it safe)

🎓 Healthcare and Social Practice

🎓 Maia

🎓 Postgraduate Student Resources

🎓 Pullman Learning Group Resources

🎓 Te Miro

🎓 TPA-ADMIN

🎓 Trades and Services

🎓 Unitec Pathways College (UPC)

🎓 Unitec Staff Resources

🎓 Unitec Student Support

🎓 New unsorted courses

🔧 TOOLBOX

📁 PORTFOLIO

📄 CERTIFICATE

🏛️ PORTAL

❓ STUDENT LEARNING AND ACHIEVEMENT

💻 ASK IT

🎓 ACADEMIC INTEGRITY

✉️ STUDENT EMAIL

🚀 CAREER & EMPLOYABILITY

🌐 INTERNATIONAL STUDENTS

🌟 TEACHING COMPETENCIES

✅ Academic Quality

code of practice

🔍

⬆️

#### 4. Please click on the Code of Practice link:

##### [Student Handbook - Social Practice Postgraduate Programmes](#)

Programmes included in this handbook: Master of Applied Practice (Social Practice) (level 9, 180 credits) Postgraduate Diploma in Applied Practice (Social Practice) (level 8, 120 credits) Postgraduate Certificate in Applied Practice (Social Practice) (level 8, 60 credits)

Handbook Soc Prac PG

[View this result in context - in course Student Handbook - Social Practice Postgraduate Programmes](#)

##### [Code of Practice](#)

Code of Practice

[View this result in context - in course Code of Practice](#)

##### [Code of Practice archive](#)

Code of Practice archive

[View this result in context - in course Code of Practice archive](#)

##### [DACA5231 - Graphic Design Practice](#)

#### 5. Please click on enrol me:

 **Moodle**  
Online learning

Code of Practice

Home / Courses / Te Puna Ako - Professional Development / Code of Practice / Enrol me in this course / Enrolment options

## Enrolment options

 [Code of Practice](#)

Teacher: [Malcolm Hay](#)  
Teacher: [Melinda Jenkins](#)

▼ [Self enrolment \(Student\)](#)

No enrolment key required.

[Enrol me](#)

## 8. You are now enrolled in the Code of Practice Module.

Use the navigation buttons at the bottom of the screen to progress through the module.

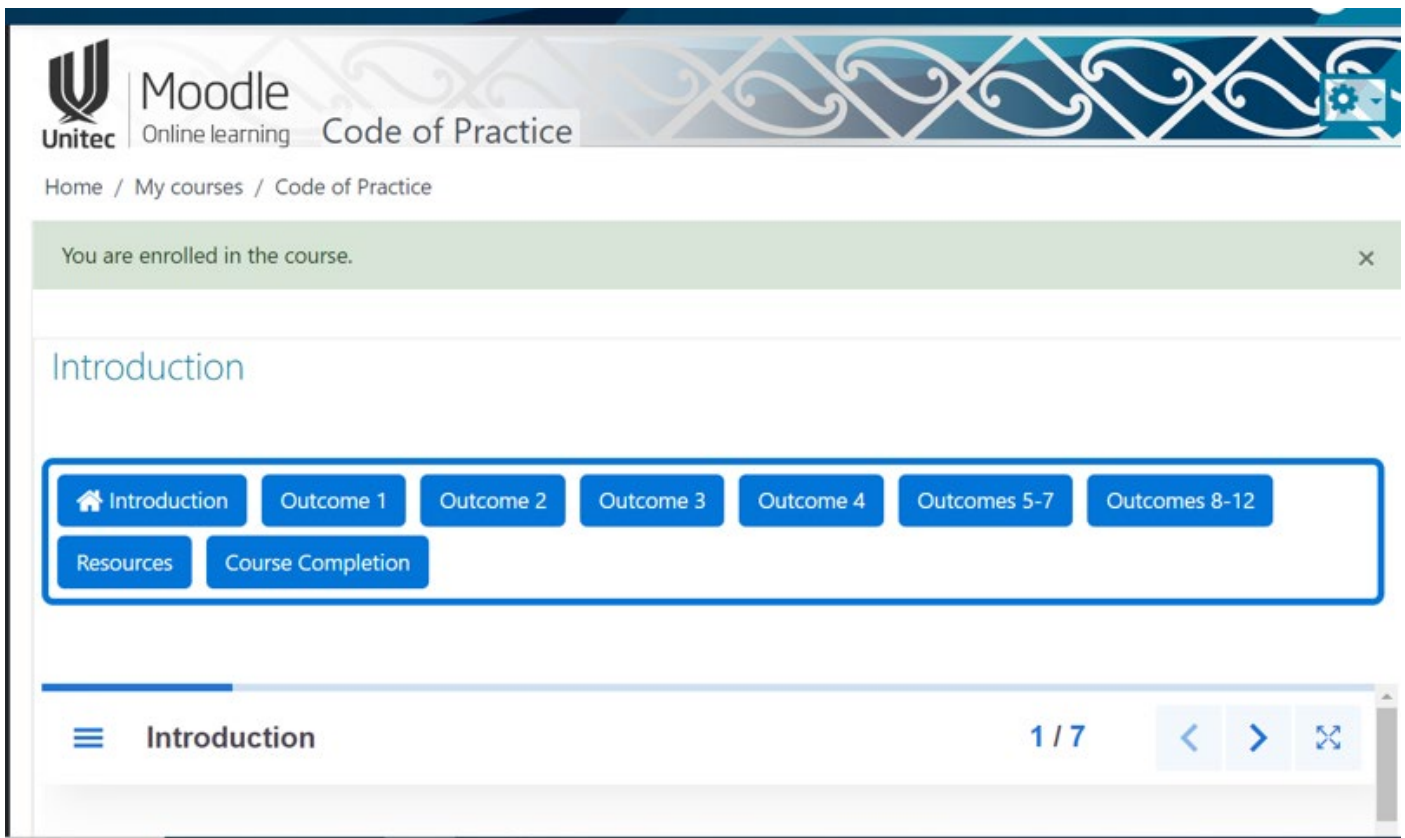

**Note:** *If you are having any trouble viewing the content, try refreshing the page. If this doesn't work, try clearing your cache. If you are still having trouble, please contact [learnanddevelop@unitec.ac.nz](mailto:learnanddevelop@unitec.ac.nz).*

**If you're having trouble opening the pop-up, it may be blocked by your browser.**

*For Chrome, you can adjust your settings with the following steps:*

<https://support.google.com/chrome/answer/95472?hl=en&co=GENIE.Platform%3DDesktop>

*For Firefox, you can adjust your settings with the following steps:*

[https://support.mozilla.org/en-US/kb/pop-blocker-settings-exceptions-troubleshooting#w\\_pop-up-blocker-settings](https://support.mozilla.org/en-US/kb/pop-blocker-settings-exceptions-troubleshooting#w_pop-up-blocker-settings)